

Harper Floor Mount Installation Guide

Adp

ATTENTION: VANITY MUST BE SECURED TO WALL. PLEASE USE GUIDE IN CONJUNJTION WITH GENERIC INSTALLATION BOOKLET.

1

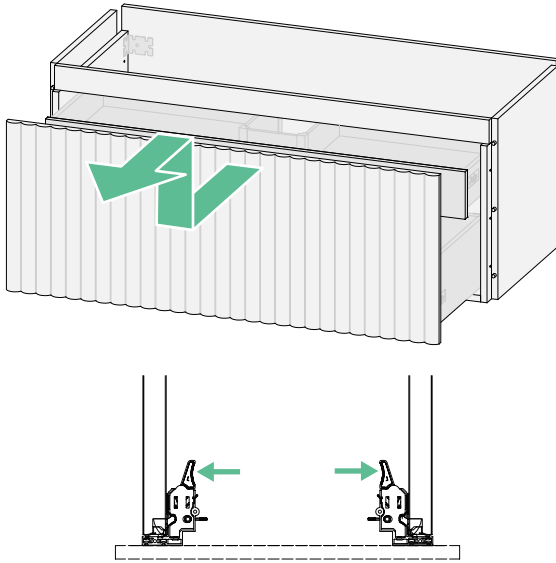

Remove all drawers from vanity by squeezing both levers in on the underside of the drawer, at the same time (to activate release) and pull drawer out to remove.

2

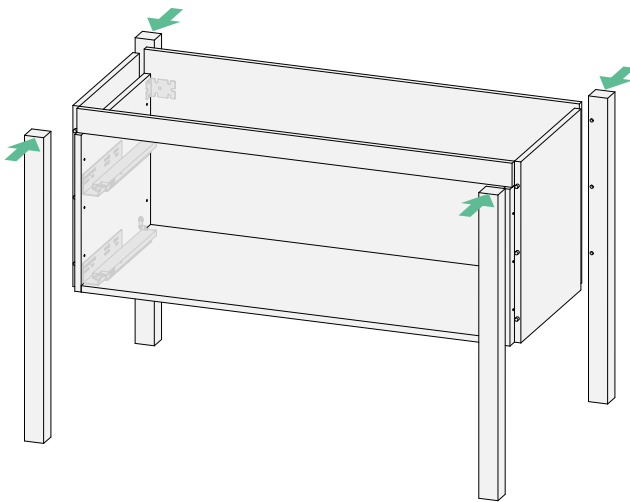

Align the legs with the dowels in the vanity end panels and lightly tap them into place ensuring a snug fit.

Note: You may want to carefully flip the vanity upside down to make this step easier.

3

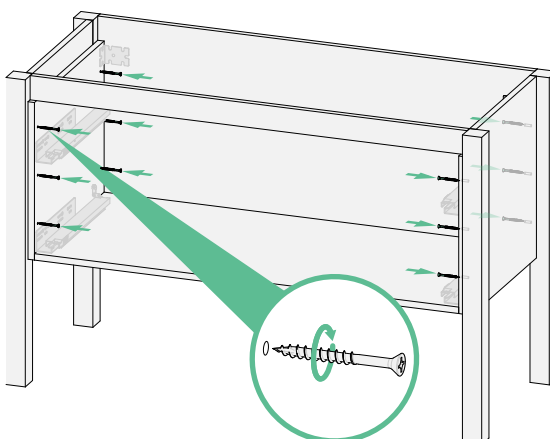

Using the provided 40mm Hospa screws, screw through the holes in the vanity ends, into the legs to secure into place.

4

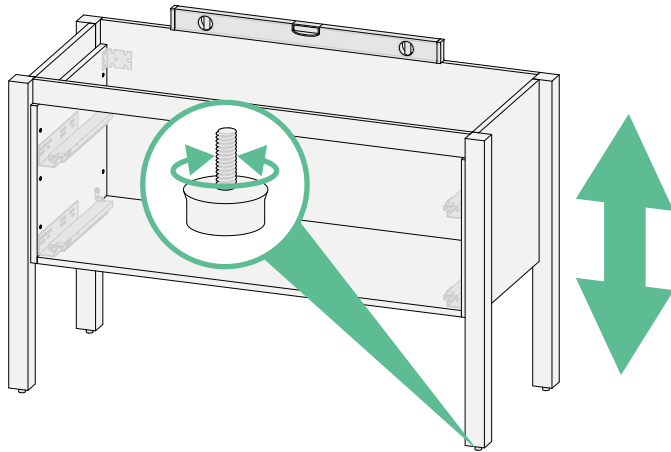

Align vanity to wall and use the adjustable feet to level, using a spirit level to ensure levelling is correct.

5

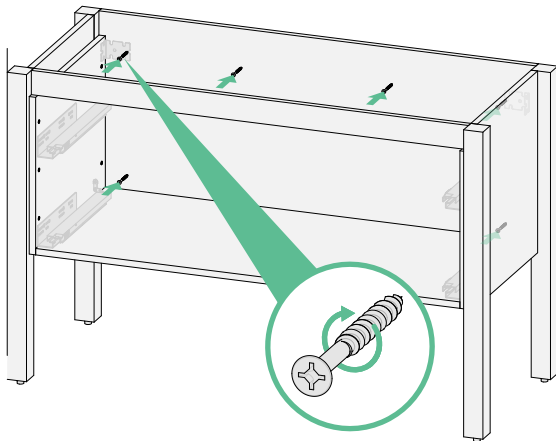

Securely fasten the vanity to the wall through back of vanity with appropriate screws/bolts at TOP and BOTTOM of cabinet. Fix the cabinet through the top left and right hand brackets and evenly space apart the horizontal fixings at a maximum of 300mm apart. For the bottom start the fixing points no further than 100mm from each end of the cabinet and no higher than 50mm from the base panel.

Note: Where a stud or support beam cannot be located, use an appropriately sized hollow wall anchor. Vanity must attach to a minimum of two support beams. Ensure fixings clear all water/electrical services in wall.

6

Please keep me

Installation Instructions
Care & Maintenance Guide
Warranty

2 Prior To Installation
4 Installation Instructions
12 Plug & waste installation
14 Drawer alignment & installation
21 Door hinge alignment & installation
24 Care & Maintenance Guide
29 Troubleshooting
30 ADP Warranty

Hey qualified tradie!
Be a legend and please
read installation instructions
inside before installation

If the product is not installed in accordance with these instructions, your ADP warranty may be void and the homeowner may have a claim against you (the installer).



Adp

Hey home owner!
Please read important
care, maintenance and
warranty info inside

vs

Finish installation using supplied generic installation booklet.

Please ensure that all steps in this guide are followed in conjunction with the supplied generic installation guide steps to guarantee correct installation of vanity.