



Installation Manual

B&H DARA BTW Suite

B&H Elong BTW Suite

BHDR001BTW1#WH

BHEL001 BTW1#WH



www.bandh.com.au

B&H Investment Group Pty Ltd



Product installation dimensions

The following * is the suggest size.

Please confirm the installation size according to the product model.

Please have a ruler ready for dimensional measurement.

V-shaped toilet



Back Inlet position

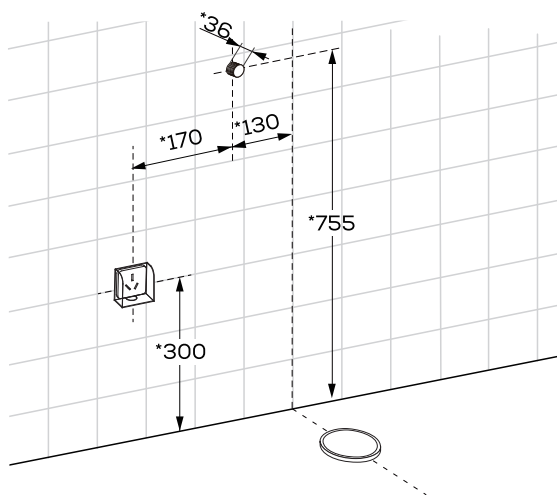

D-shaped toilet



Back Inlet position

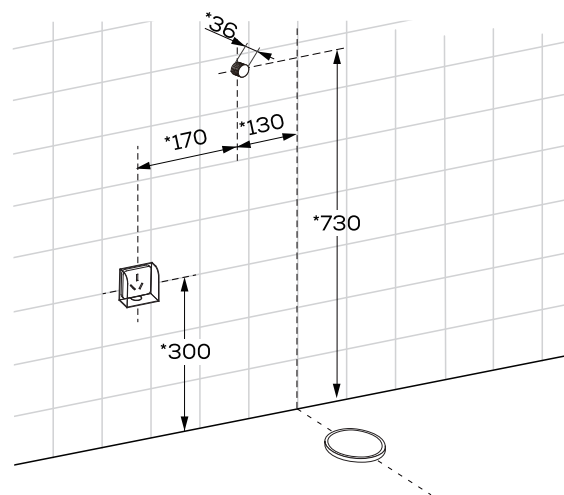

Bottom Inlet position (Left)

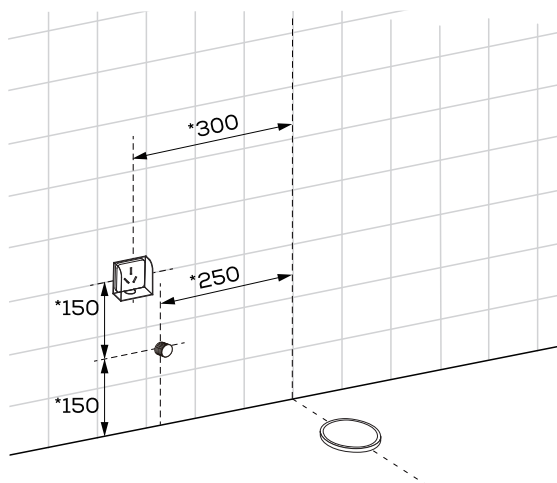

Bottom Inlet position (Right)

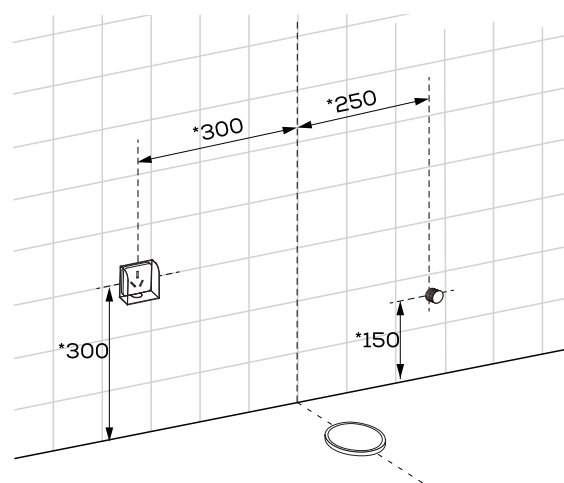

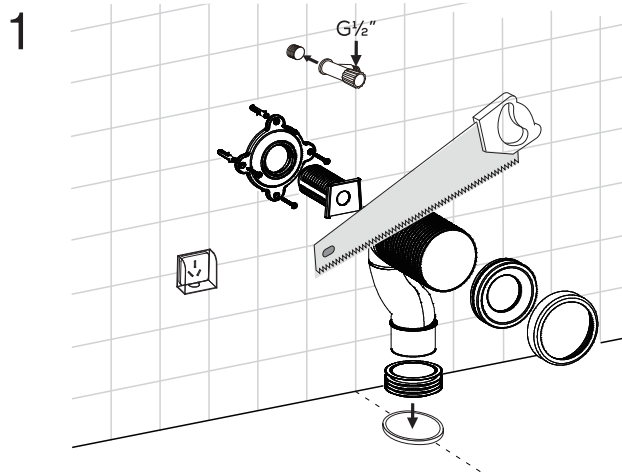

Please purchase your own sewage pipes
Cut the sewage pipe according to the actual situation

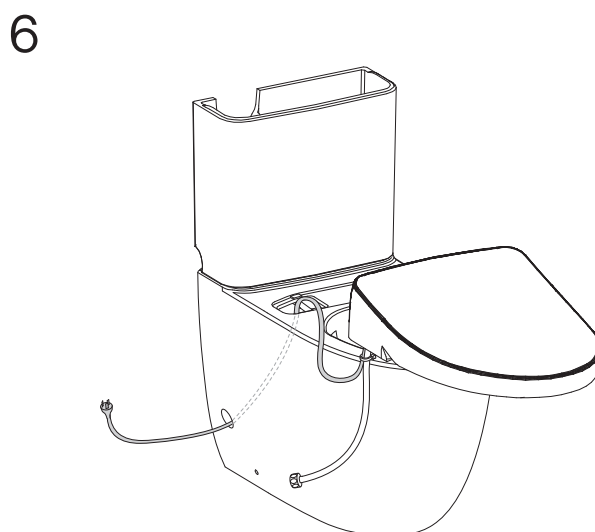
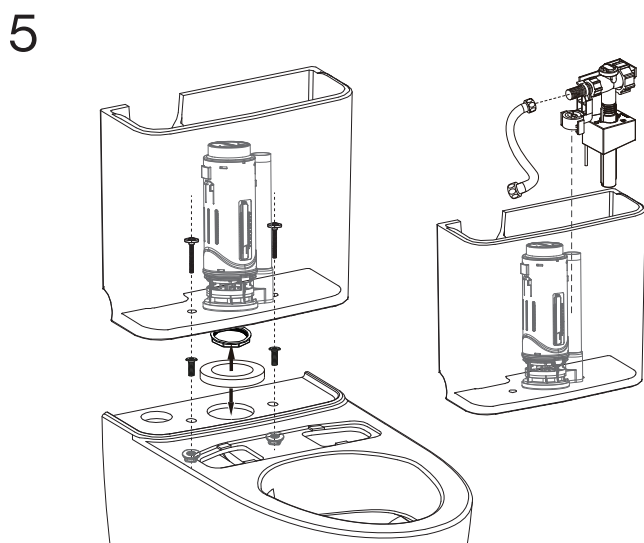
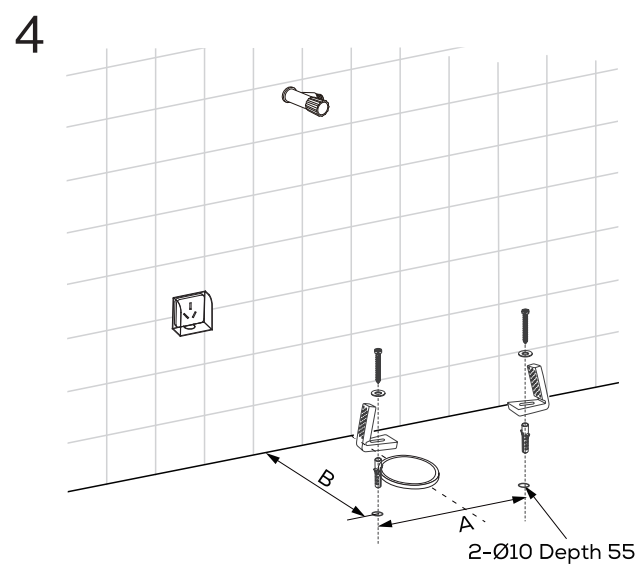
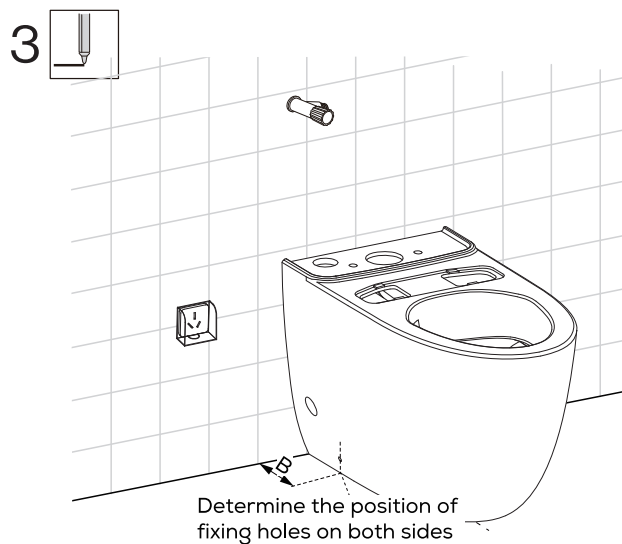
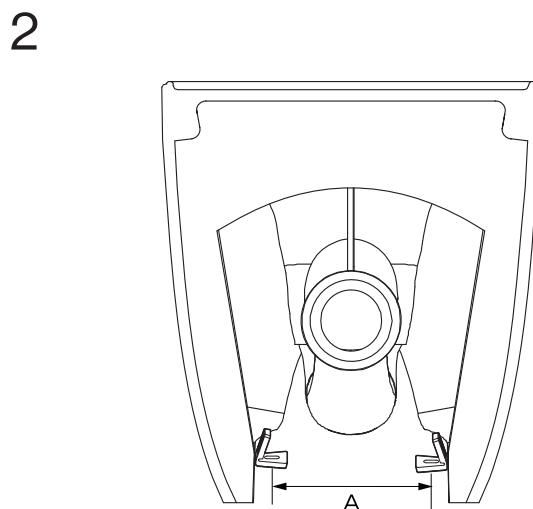

**7.1.1**

Back Inlet position

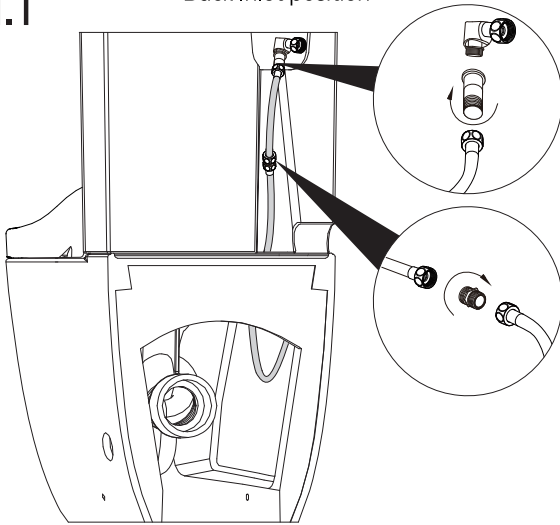
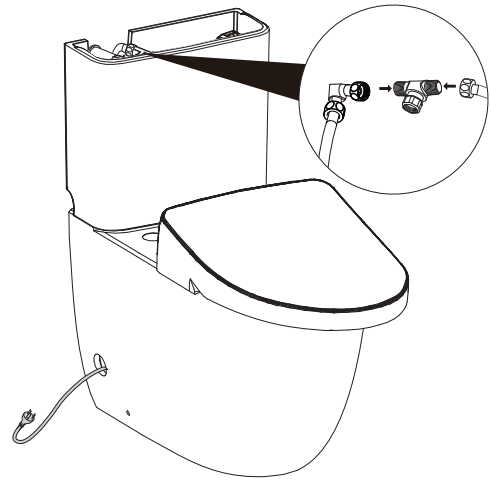
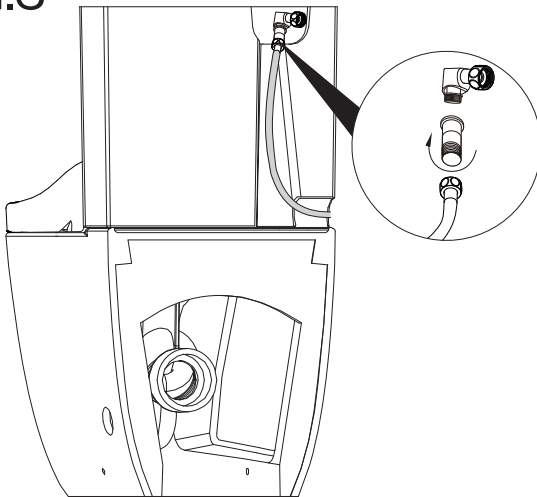
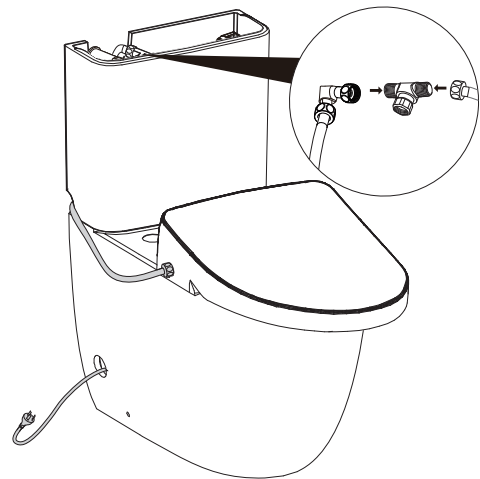
**7.1.2****7.1.3****7.1.4****7.2.1**

Bottom Inlet position (Left)

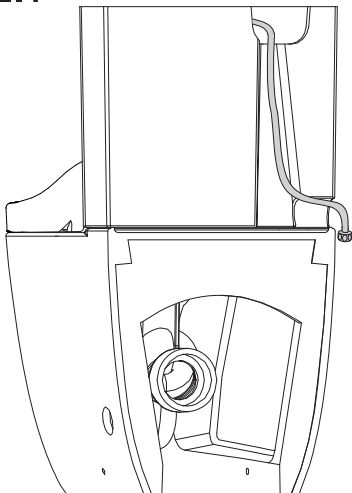
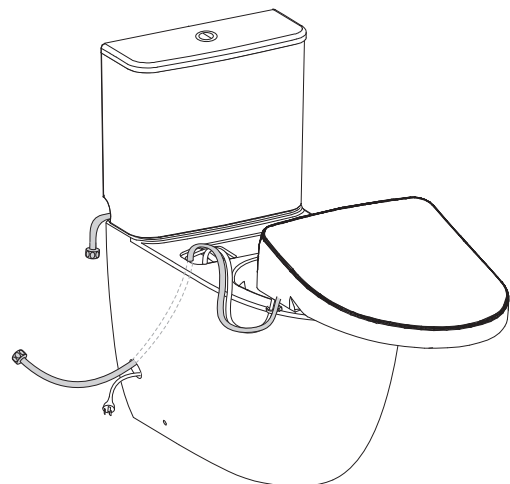
**7.2.2**

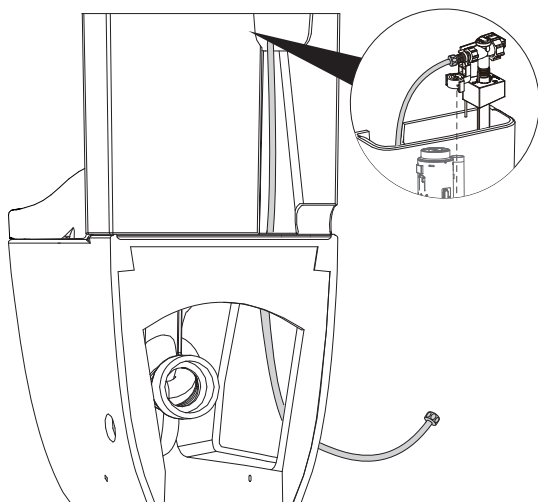
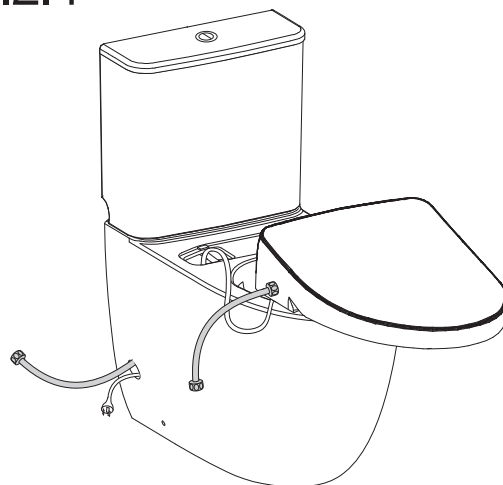
**7.2.3****7.2.4****7.3.1**

Bottom Inlet position (Right)

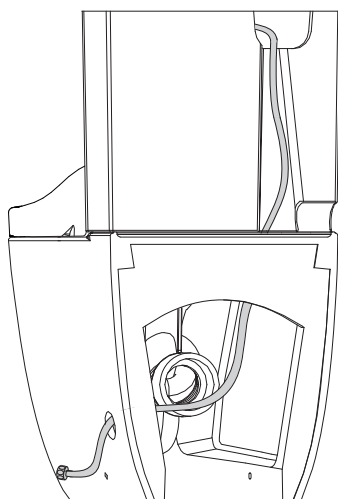
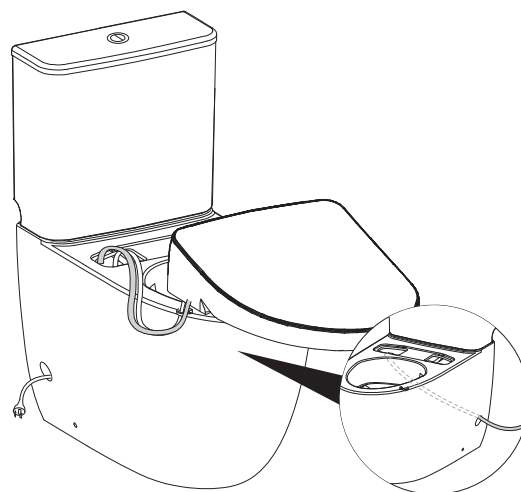
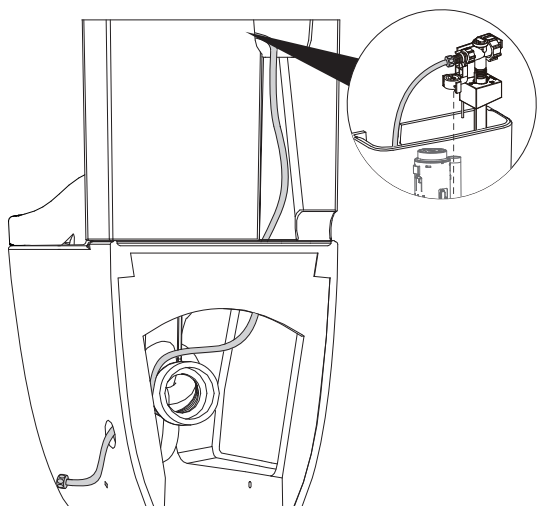
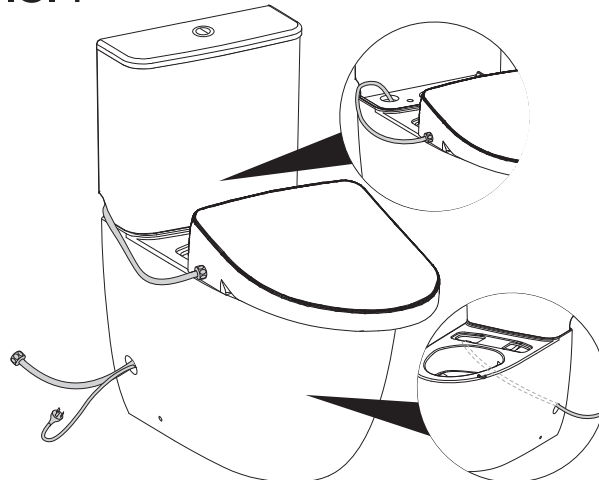
**7.3.2****7.3.3****7.3.4**

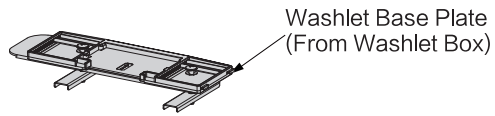
**8**

Washlet Base Plate
(From Washlet Box)

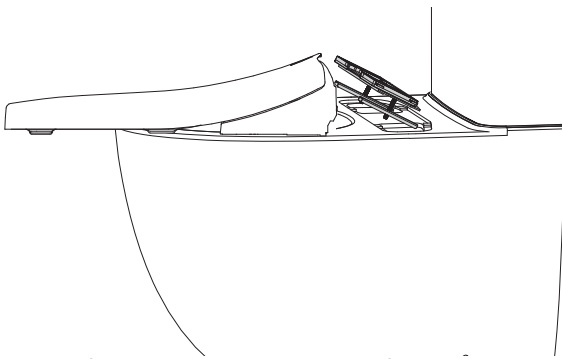

Please refer to the instruction manual for cover plate installation.

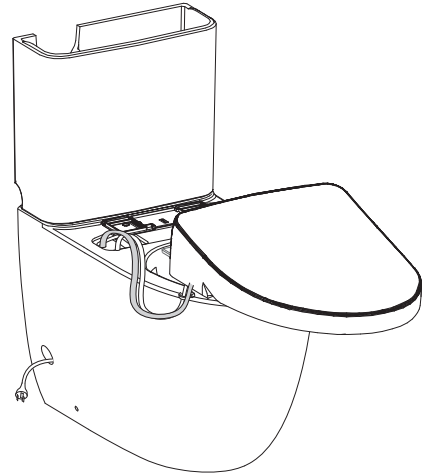
9

Place the bottom plate properly and find the balance.

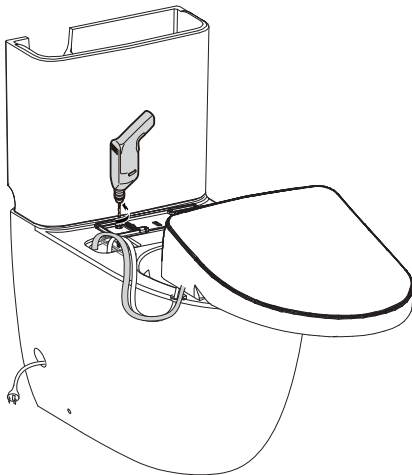
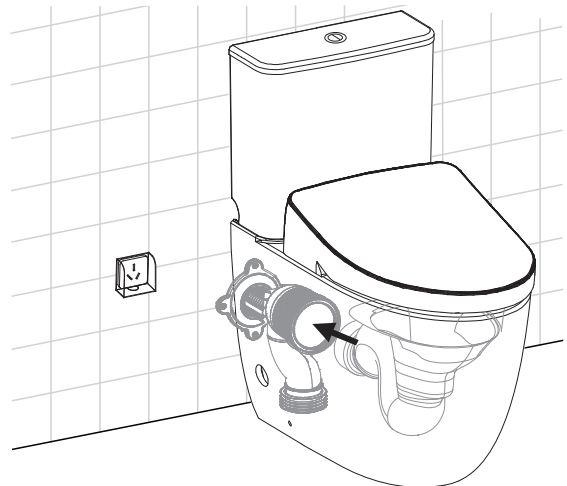
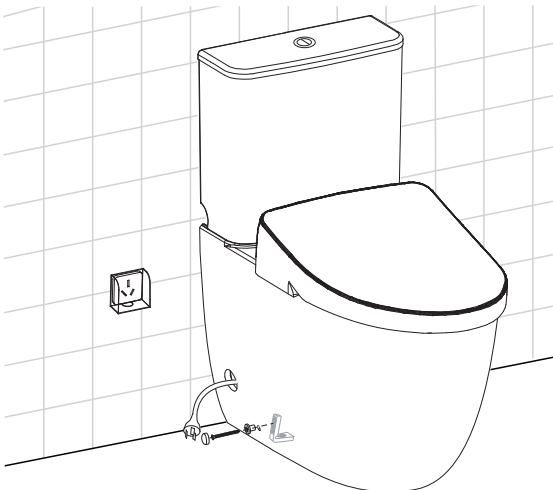
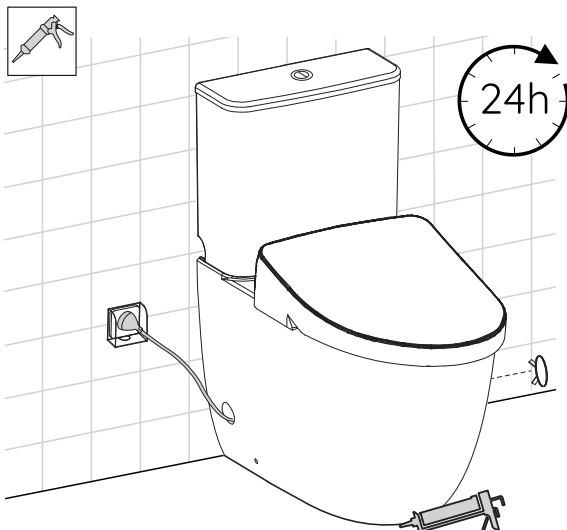
10**11****12****13**

The instructions shall incorporate the requirements of AS/NZS 3500.1 and AS/NZS 3500.2, and should comply with Plumbing code Australia.



Installation effect drawing

Back Inlet position
For CCT WASHLET

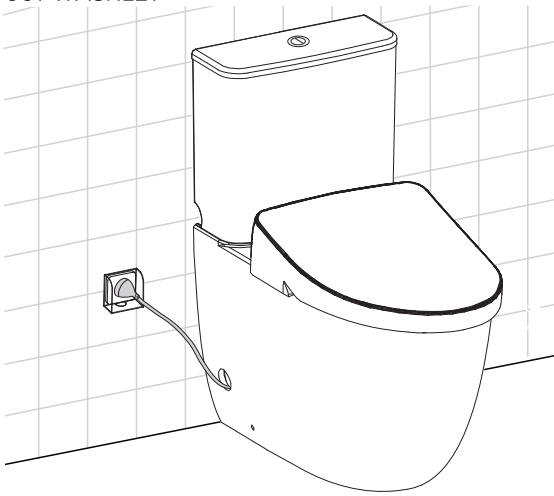

For Non-CCT WASHLET

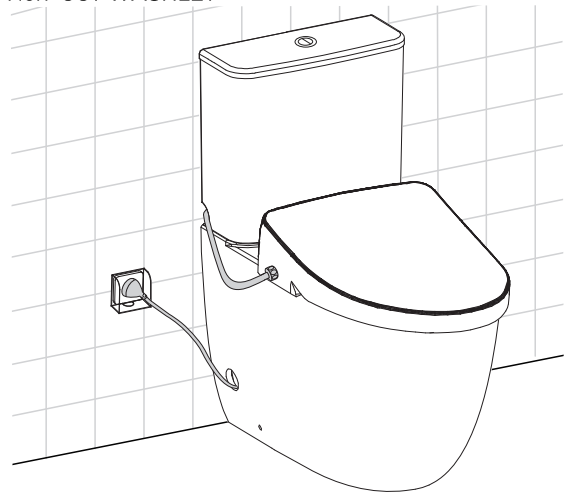

Bottom Inlet position (Left)
For CCT WASHLET

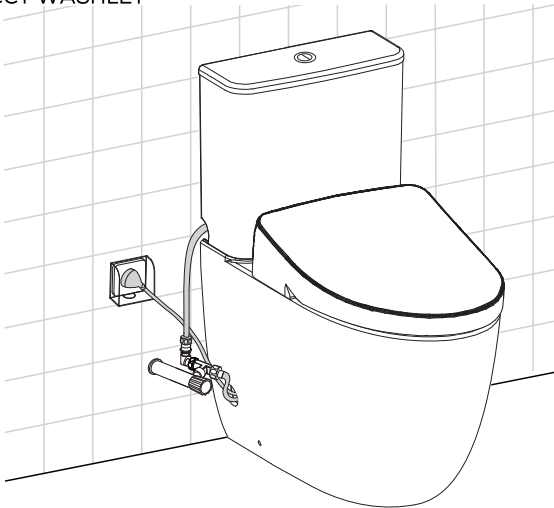

For Non-CCT WASHLET

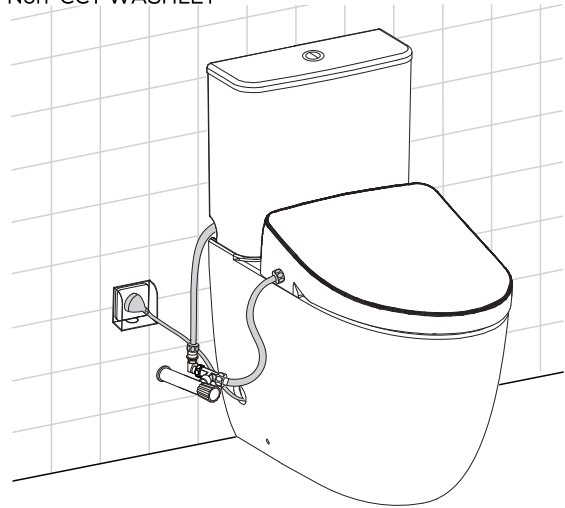

Bottom Inlet position (Right)
For CCT WASHLET

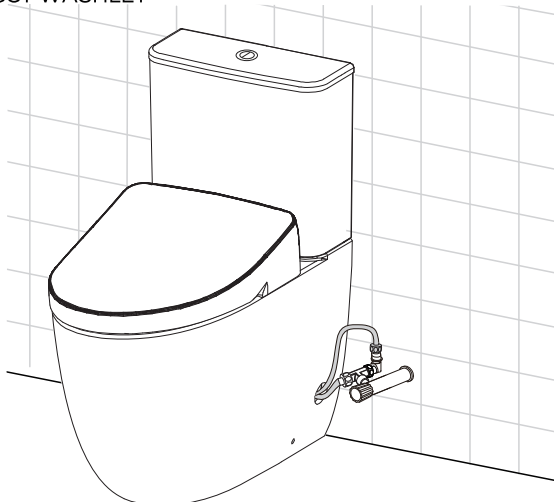

For Non-CCT WASHLET

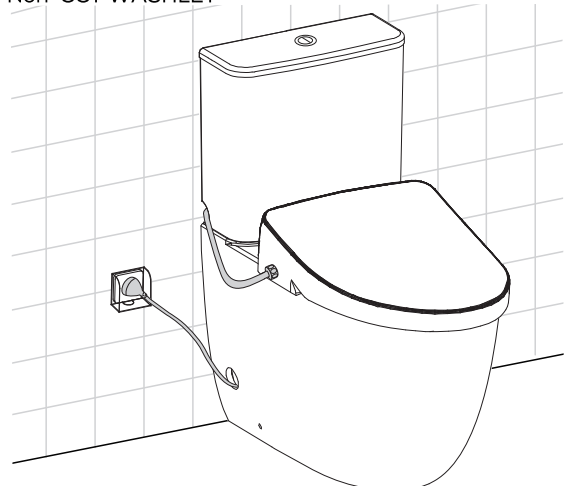



www.bandh.com.au

B&H Investment Group Pty Ltd

2024.06

P/N:224000167701