



Revision: 0

Date: October 2020

Supersedes all previous issues

Urbane II

Ceramic Under Counter Vanity Basin

Nominal Size: 540mm x 370mm



Urbane II



Tapware shown is not included.

The Urbane II basin range features refined thin edge details, contemporary rectangular forms, and a practical, easy-to-clean bowl. Designed to enhance the complete Urbane II bathroom collection, the basin range is available in a range of configurations, ideal for general purpose, domestic and commercial applications.

Tap Holes: Basin available in: No tapholes Code No.878500.

Waste Outlet: The basin has been design and supplied with an integrated waste with a white ceramic pop up waste cap. To colour match to tapware and bottle trap, optional wastes are available with brass waste caps in 5 finishes, Black (B), Brushed Brass (BB), Brushed Nickel (BN), Chrome (C) and Gunmetal Grey (GM). Code No.687330.

Bowl Capacity: 10.2 litres.

Overflow: Overflow not available.

Fixing: The underside of the basin rim must be sealed to the counter top with an acetic cured silicone sealant. **Epoxy type glues must not be used.** The basin is supplied with a template which must be used for the counter top cut-out.

Colours: White only.

Dimensions: All dimensions are in millimetres and are subject to normal manufacturing variations. Caroma pursues a policy of continuing improvement in design and performance of its products. The right is therefore reserved to vary specifications without notice.

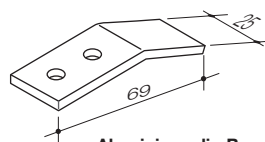
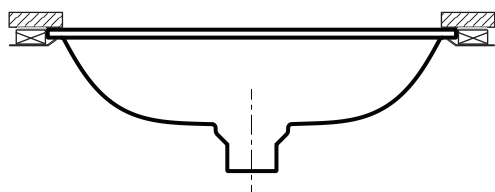
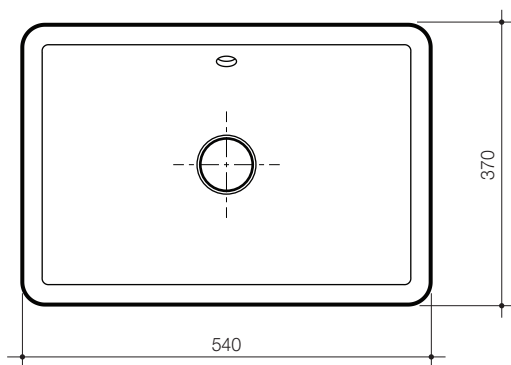

Aluminium clip Bracket
Code No.813734

Marble or Granite top fixing

