

CLASSIC DUO OVAL FREESTANDING

- pure simplicity and unpretentious elegance are what distinguish these baths
- bathing with a friend: two identical back rests and centrally positioned waste
- the moulded panel emphasises the high design standard
- made of KALDEWEI steel enamel
- **30 YEAR WARRANTY**

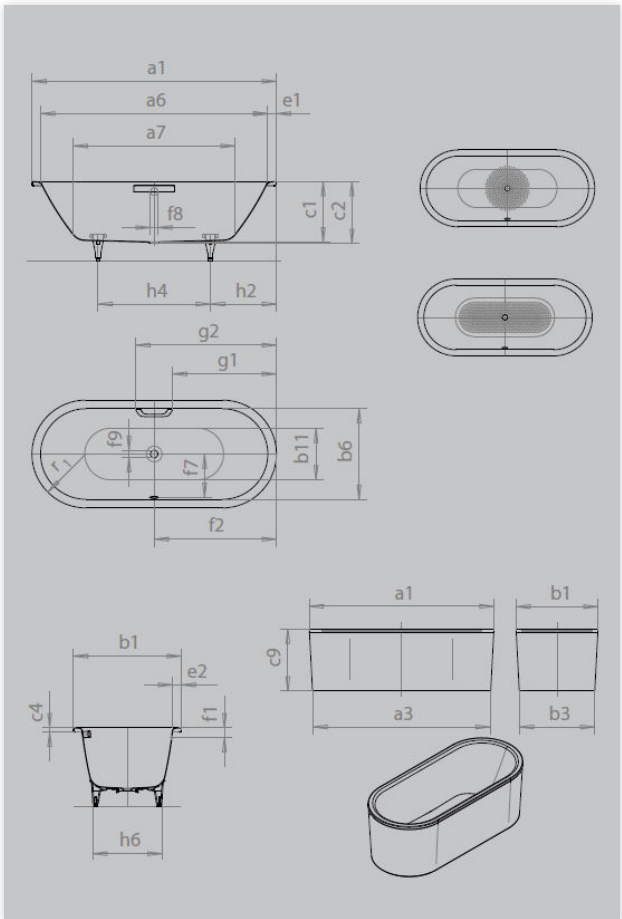

GRIP DISCREET OPULENCE



Model No.		112-FS	113-FS	111-FS
External length	a ₁	1600	1700	1800 mm
External length (bottom)	a ₃	1481	1635	1735 mm
Internal length (top)	a ₆	1480	1580	1680 mm
Inernal length (bottom)	a ₇	1030	1130	1230 mm
External width	b ₁	700	750	800 mm
External width (bottom)	b ₃	575	685	735 mm
Internal width (top)	b ₆	580	630	680 mm
Internal width (bottom)	b ₁₁	450	500	550 mm
Depth inside	c ₁	420	420	420 mm
Depth incl. waste hole	c ₂	430	430	430 mm
Height of rim	c ₄	32	32	32 mm
Overall height with panel	c ₉	602	602	602 mm
Width of rim (foot end; long side)	e ₁ ; e ₂	60; 60	60; 60	60; 60 mm
Distance top edge to centre of overflow hole	f ₁	70	70	70 mm
Distance bath edge to centre of waste hole	f ₂	800	850	900 mm
Distance centre of waste hole to centre of overflow hole	f ₇	280	305	330 mm
Diameter of overflow hole	f ₈	Ø 52	Ø 52	Ø 52 mm
Diameter of waste hole	f ₉	Ø 52	Ø 52	Ø 52 mm
Distance bath edge (foot end) to start of grip	g ₁	672	722	772 mm
Distance bath edge (foot end) to end of grip	g ₂	928	978	1028 mm
Distance foot end of bath edge to centre of foot	h ₂	560	560	600 mm
Distance between the feet	h ₄	480	580	600 mm
Width of feet max.	h ₆	410	450	540 mm
External radius	r ₁	350	375	400 mm
Water volume		95	124	158 l
Net weight		74	78	88 kg
Diameter of Anti-slip		Ø 288	Ø 435	Ø 435 mm
Full anti-slip		850 x 240	900 x 300	900 x 300 mm

Subject to technical alterations, tolerances and errors. Similar illustrations.
 ** 70 litres displacement on average.