

GENERAL INFO
PREMIUM DEDICATED FILTER TAP RANGE

A range of stylish faucets with all-round appeal. Puretec's DFU Series comes in 6 different design choices, meaning there is a tap design to suit every kitchen style. The DFU Series also features variable flow and ceramic disc technology, so you can enjoy years of trouble-free service, backed by a 3 year warranty^.



DFU110



DFU130



DFU135



DFU155



DFU170



DFU180

SPECIFICATIONS

Max Flow:	7 Litres/Minute
Min/Max Temperature:	0°C - 52°C
Min/Maximum Pressure:	200 - 500* kPa
Connection:	1/4" tube [7/16" BSP]
Required Hole for the Tap:	12.5 mm diameter
Warranty:	3 years^

^3 year warranty is 1 year parts and labour, plus 2 years parts only. *Where line pressure exceeds 500 kPa, an approved pressure limiting device must be installed to comply with Australian & New Zealand Plumbing Standards. (Ref. AS/NZS 3500.1:2021, Clause 3.3.4).

MODEL CODES

Ordering Code:	Description:
DFU110	High Loop, 1/4 turn, all chrome
DFU130	Long Reach, 1/4 turn, all chrome
DFU135	Long Reach, 1/4 turn, all chrome
DFU155	Goose Neck, 1/4 turn, spindle lever
DFU170	Contemporary, 1/4 turn, all chrome
DFU180	High Loop, 1/4 turn, all chrome

Puretec manufactures and distributes a huge range of water filters compatible with the DFU Series faucets.

DFU110

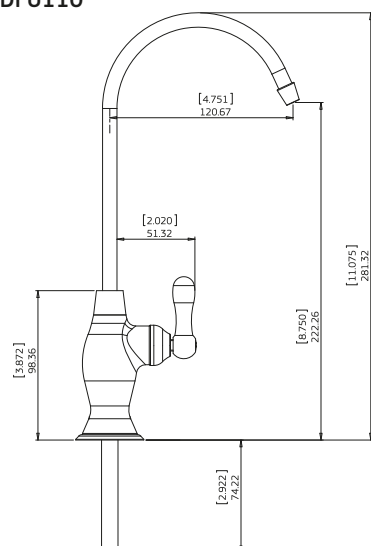

Technical drawing of the 7/16" 24UNS robot arm in its retracted position. The drawing shows the arm's profile with various dimensions in inches and millimeters. Key dimensions include a base height of 71.05 inches [2798], a display height of 72.49 inches [2854], a total height of 214.89 inches [8460], and a reach of 97.65 inches [3966]. The arm's diameter is 9.50 inches [0.374]. The drawing is labeled "7/16" 24UNS" and "DISPLAY".

Technical drawing of the 7/16-24UNC mounting bracket for the 1000 Series. The drawing shows a side view of the bracket with various dimensions. The total height is 239.10, with a base height of 118.65. The mounting arm has a length of 146 and a height of 183.10. The base has a width of 64.20 and a mounting hole diameter of 7/16-24UNC. The drawing also shows a top view of the bracket with a width of 118.65 and a height of 183.10.

Technical drawing of a vertical assembly, likely a lamp or light fixture, showing dimensions in inches [] and millimeters [].

Dimensions (inches [] / millimeters []):

- Top horizontal distance: [4.821] / 122.44
- Right vertical distance: [9.088] / 230.83
- Left vertical distance (top section): [3.146] / 79.30
- Left vertical distance (middle section): [1.053] / 26.78
- Left vertical distance (bottom section): [1.178] / 29.91
- Bottom vertical distance: [3.025] / 76.10
- Horizontal distance from left edge to center of bottom section: [0.374] / 9.50
- Horizontal distance from left edge to center of middle section: [0.374] / 9.50
- Horizontal distance from left edge to center of bottom section: [1.178] / 29.91
- Horizontal distance from left edge to center of middle section: [1.053] / 26.78
- Horizontal distance from left edge to center of top section: [0.374] / 9.50

Other labels:

- 7/16-24UNS (thread specification)
- Ø27 (diameter)
- Ø35 (diameter)
- Ø9.50 (diameter)

SPARES



BFB078

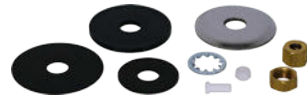

DFU-FC



DFU-FC155



DFU-FC180/250



KTA48

Ordering Code:	Description:
BFB078	Faucet to Ezy Hooker Bush, chrome plated brass, 1/2" M x 7/16" F
DFU-FC	Faucet mounting components kit,
DFU-FC155	Faucet mounting components kit, suits DFU155
DFU-FC180/250	Faucet mounting components kit, suits DFU180/OT250
KTA48	Tap adaptor (faucet adaptor), 1/4" Tube x 7/16" F
KTA68	Tap adaptor (faucet adaptor), 3/8" Tube x 7/16" F

Note:

1. No claims can be made based on the specifications and images in this document. The design, technology, colours, features and prices are subject to change.
2. This document and all its contents are copyright protected. All rights are reserved, particularly alteration, translation and reproduction using electronic systems.
3. ^Warranties in this document cover parts for the period stated and include cover for parts and labour for the first year where applicable, subject to approval. Plus 2 years parts only.

Our Water Filtration Specialists can provide you with advice to suit your needs.