

# Circa

## Floormount mixer Fixing distances

SUSSEX

### Product code

RFMCT	Floormount mixer	RFMHT	Floormount mixer with hand shower
RFMCT-V	Floormount mixer - Vertex	RFMHT-V	Floormount mixer with hand shower - Vertex
RFMBMCT	Floormount basin mixer		
RFMBMCT-V	Floormount basin mixer - Vertex		

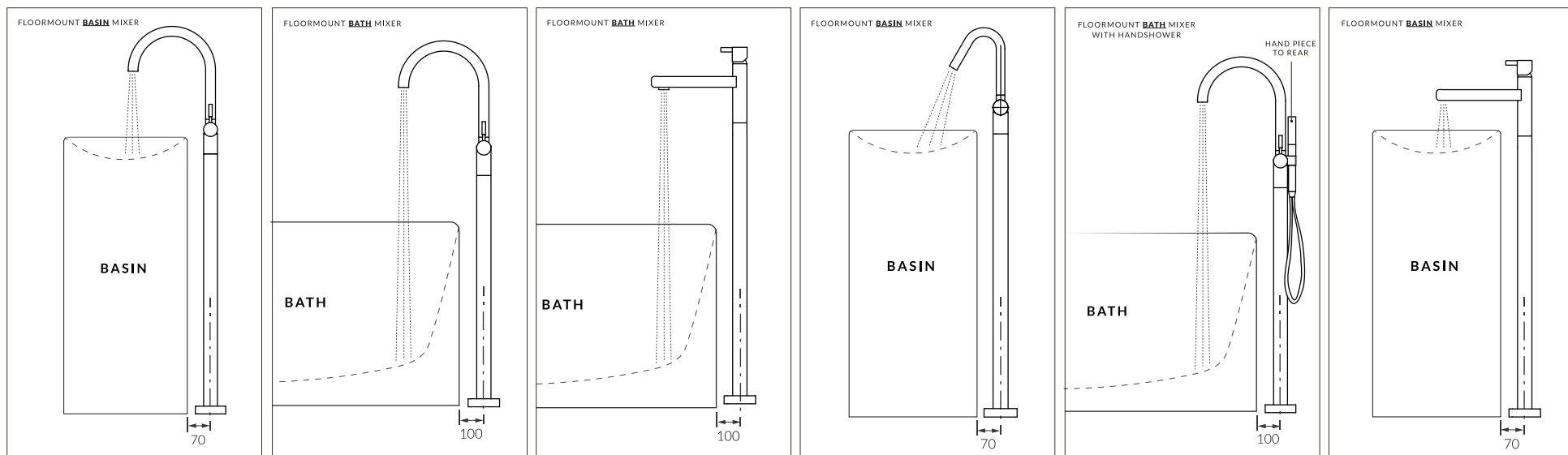

Diagram illustrating the components of a floormount mixer valve assembly:

- END CAP
- PRESSURE PLATE
- BHM DYNABOLT (X4)
- ELBOW (X2)
- CONCRETE SURFACE
- 50mm CONCRETE RECESS
- HOT
- COLD
- FRONT
- CONNECTION FITTING
- FLOORMOUNT MIXER VALVE BODY
- FLOORMOUNT MIXER VALVE BASE PLATE

- After mortar has set, seal the area between mortar and the Fixing Valve.

# Circa Floormount mixer Wooden floor Rough-in

SUSSEX

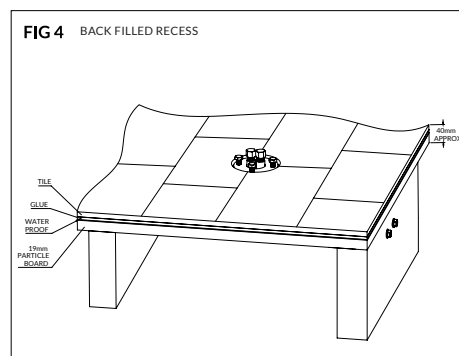
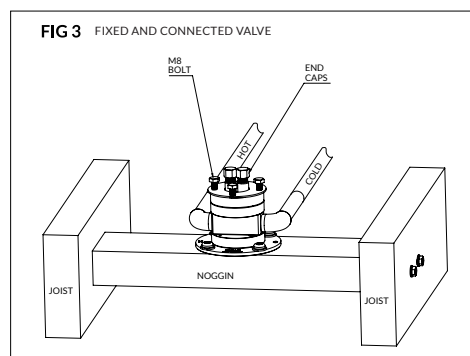
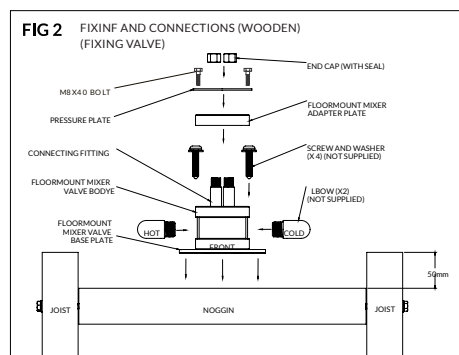
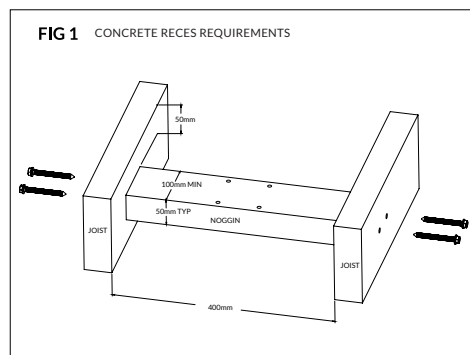

## Rough-in (Wooden floor)

- Fix a 100x50mm min noggin. 50mm below the top of the joists in the position where the floormount mixer is to be located (Fig. 1).

**NOTE:** the floormount mixer has been supplied to suit a concrete installation. Some parts need to be changed to suit a wooden floor.

- To suit wooden flooring, remove the m8x25mm bolts and the pressure plate. Using a 6mm allen key, remove the two connection fittings (O-ring sealed) and replace with the longer version (tighten well).
- Add the Floormount Mixer Adapted Plate. Replace the Pressure Plate and loosely fit the M8x40mm bolts (Fig. 2).

**NOTE:** the shorter connection fittings and M8x25mm bolts will not be required.

- Add appropriate elbows or 1/2" BSP nipples to allow for hot/cold water connections (not supplied).
- Secure Floormount Mixer Valve to coggin using appropriate wood screws (not supplied).

**NOTE:** "FRONT" to face water vessel.

- Complete hot/cold water connections.
- Ensure the valve is level and well anchored.

## Fixing and connections (Fig. 2 & 3)

- Connect 1/2" elbows (or male/female nipples) to Fixing Valve in preparation for the hot/cold water lines.
- Position fixing valve into concreted recess area.

**NOTE:** Align "Front" to face bath or wash vessel.

- Mark and drill for 8mm "dyna bolt" or other appropriate anchoring bolts (not supplied).
- Fix Floormount Fixing Valve and complete hot and cold water line connections.
- Ensure the valve is level and well anchored.
- Tighten "end caps" and perform water testing, and ensure there are no water leaks.
- Leave end caps, pressure plate and fixing bolts in the valve to protect the threads until final fit-off.

## Back-filled recess (Fig. 4)

- Once all water connections are made and tested, fill in the recessed area and channelling up to the Fixing Valve with a mortar mix.
- After mortar has set, seal the area between mortar and the Fixing Valve.

# Circa Floormount mixer Installation kit Fit-off

SUSSEX

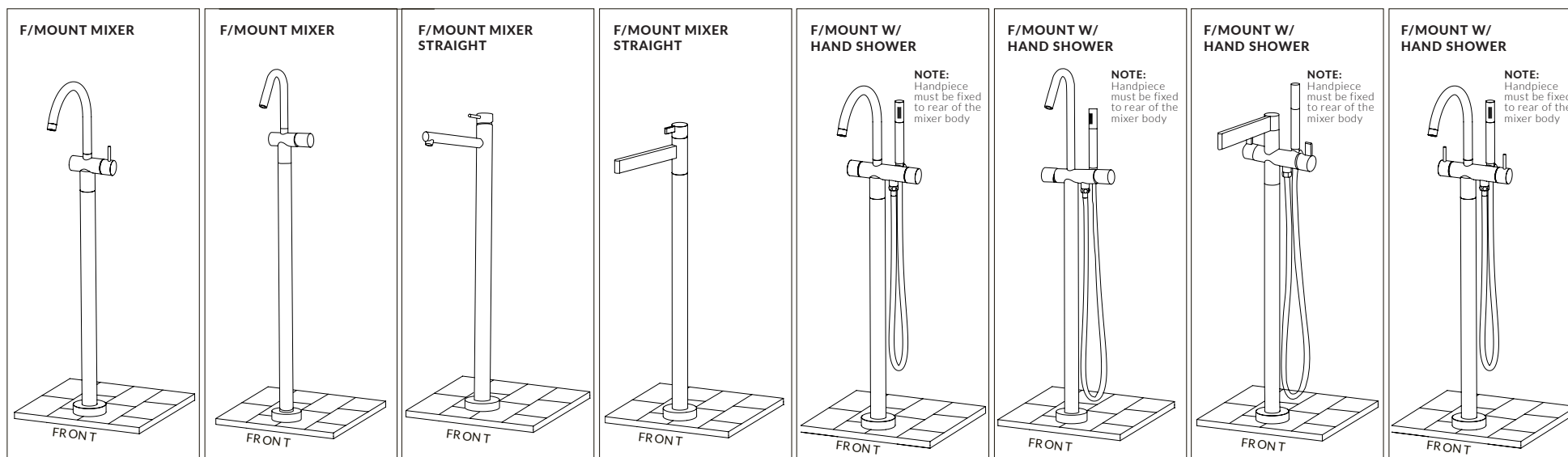

# Circa Floormount mixer Concrete floor Fit-off

SUSSEX

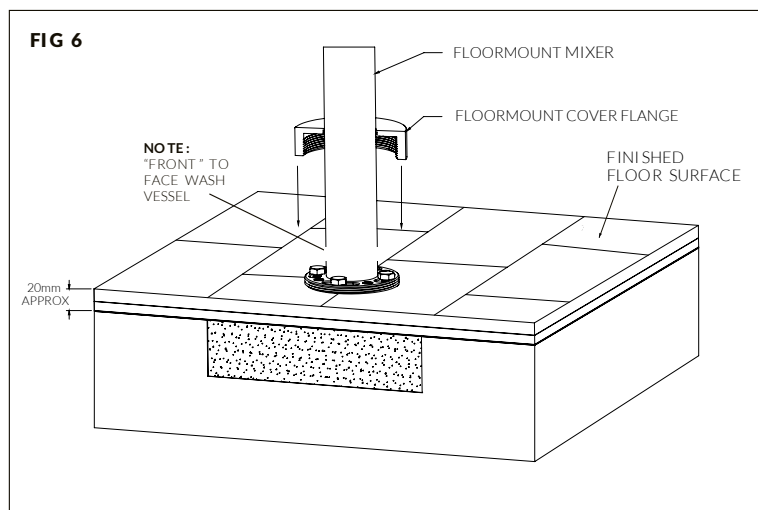
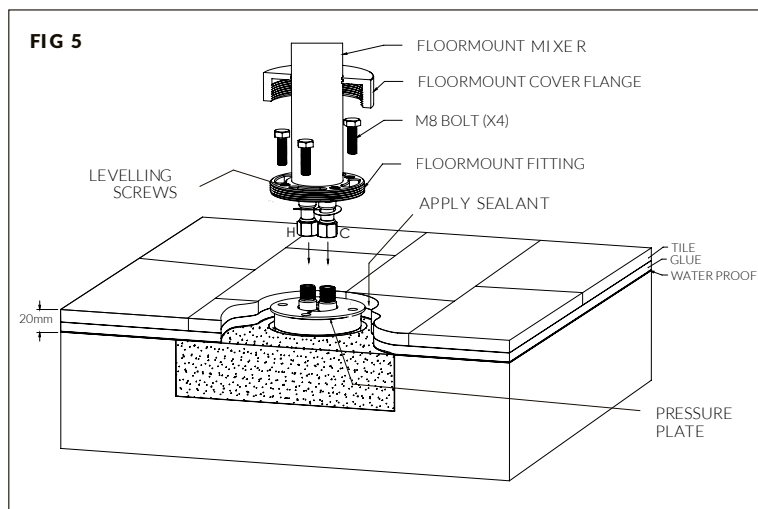

## Fit-off (Concrete floor)

- Prior to installing, ensure floor around fixing valve is completely sealed.
- Raise the floormount cover flange.
- Remove "end caps" and retain if required.
- Connect hot and cold hoses from Floormount Mixer (a second person may be required to assist).

**NOTE:** the hose connection has a self sealing fitting. No sealant is required.

- Tighten the hex nuts of the hose fittings using an appropriate spanner (tighten well).
- Carefully lower the mixer to meet the pressure plate.

**NOTE:** "Front" of Floormount Mixer must face the bath or wash vessel.

- Align and fit supplied M8 bolts.
- Before fully tightening, allow water flow and check for water leaks.
- Tighten M8 bolts and check Floormount Mixer is level. If levelling is required, loosen M8 bolts and adjust levelling screws as required.
- To complete the installation, lower the cover flange until it meets the finished floor surface.
- Check mixer function and look for any leaks.



AS/NZS 3718:2005  
LIC. 20081

# Circa Floormount mixer Wooden floor Fit-off

SUSSEX

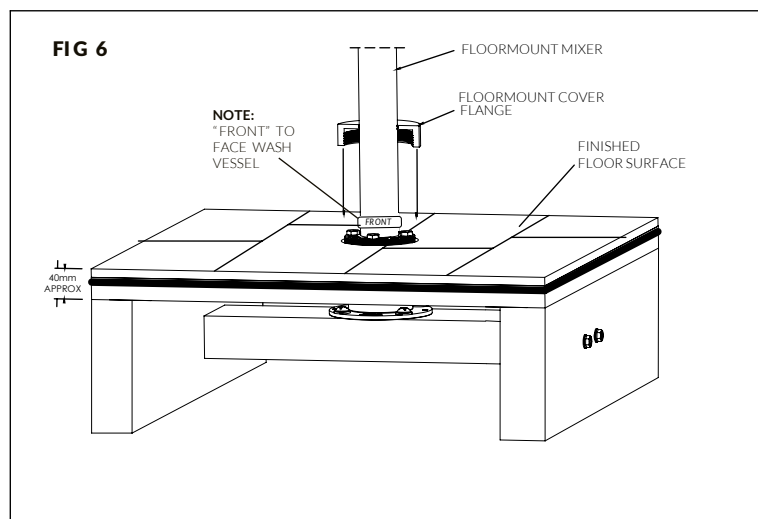
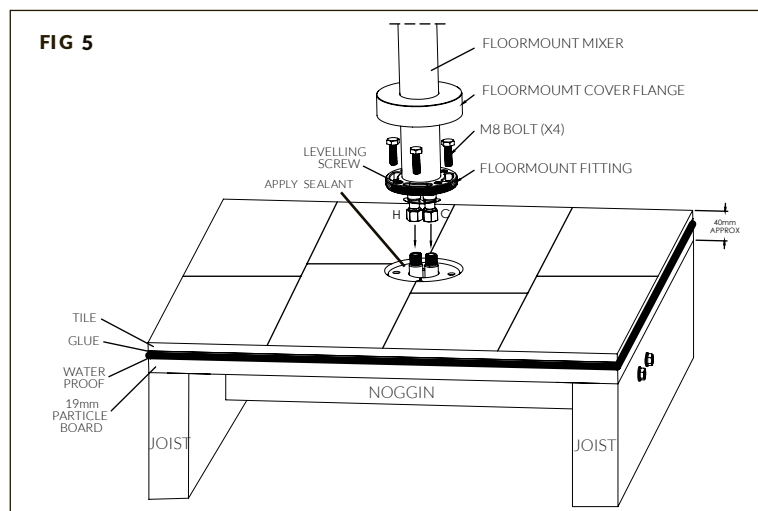

## Fit-off (Wooden floor)

- Prior to installing, ensure floor around fixing valve is completely sealed.
- Raise the floormount cover flange.
- Remove "end caps" and retain if required.
- Connect hot and cold hoses from Floormount Mixer (a second person may be required to assist).

**NOTE:** the hose connection has a self sealing fitting. No sealant is required.

- Tighten the hex nuts of the hose fittings using an appropriate spanner (tighten well).
- Carefully lower the mixer to meet the pressure plate.
- **NOTE:** "Front" of Floormount Mixer must face the bath or wash vessel.
- Align and fit supplied M8 bolts.
- Before fully tightening, allow water flow and check for water leaks.
- Tighten M8 bolts and check Floormount Mixer is level. If levelling is required, loosen M8 bolts and adjust levelling screws as required.
- To complete the installation, lower the cover flange until it meets the finished floor surface.
- Check mixer function and look for any leaks.