

Novi 50 x 46 Fine Fireclay Matte Black Farmhouse Butler Sink

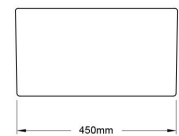
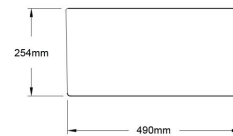
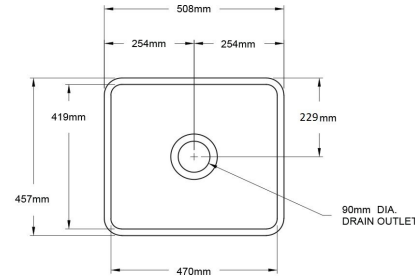

TRADITIONAL & HAMPTONS STYLE SPECIALISTS

BATHROOM | KITCHEN | LAUNDRY

Specifications

- Material: Fine Fireclay
- Finish: Matte Black
- Waste outlets included: 90x50mm Stainless Steel Basket Wastes
- Product weight: 27kg
- Mounting options: Butler (front showing), Counter Top, Under Counter (shelving required as shown in image)
- Capacity: 41L
- Internal depth: 210mm
- Approx. external radius: 45 mm
- Suitable for use with food waste disposer – we recommend purchase of an extended flange and a model with anti-vibration collar
- This sink is reversible, so it can be installed with flat or ribbed/farmhouse side facing out.
- Note: Fine Fireclay is a natural product and therefore subject to variations. This should be seen as a quality that adds to its unique natural beauty. Variations +/- 2% to the specifications are common and acceptable and are within industry tolerance. We always recommend the cabinet maker and stone provider has the actual sink with them to measure before making cabinetry or cutting stone. For more information please visit our Installation Care & Warranty page or Contact Us.

Product Options

NO50FS-MB: Novi 50 x 46 Fine Fireclay Butler Sink

NO50SSG: Novi 50 x 46 Stainless Steel Grid

RSM4032: Protective Rubber Sink Mat 400 x 320mm

NO50FS-MB-OF: Novi 50 Fine Fireclay Butler Sink With Overflow

Warranty

For peace of mind, Turner Hastings offers the following warranty on this product and its components:

Fine fireclay - Lifetime

For more details, [click here](#) to refer to our warranty page.