

**AXOR One**  
**Thermostatic module for concealed installation for 2 functions**  
 Finish: **Chrome** Article Number: **45712003**



### product features

- 2 functions and 1 additional outlet
- simultaneous use of several outlets
- comfortable turning on / off of outlets with large Select-paddle
- thermostat cartridge, Start/stop valve to operate the functions, ceramic valves 90°
- flow rate per outlet: 24 l/min
- flow rate by simultaneous use of all outlets: 30 l/min
- maximum flow rate at 3 bar: 30 l/min
- min. operating pressure: 1 bar
- max. operating pressure: 10 bar
- Safety stop at 40 °C
- temperature limitation adjustable
- the thermostat offers the possibility for thermal disinfection
- non-return valve
- connection type: basic set
- thermostat is delivered with buttons hand shower and Rain large

### Technology

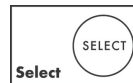

### Certificates / Sustainability



### Product image



### Scale drawing

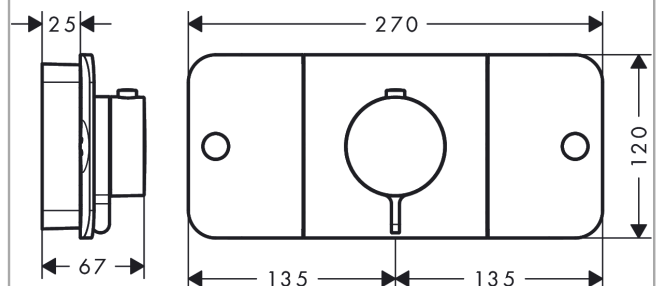

**AXOR One**  
**Thermostatic module for concealed installation for 2 functions**  
 Finish: **Chrome** Article Number: **45712003**



## Flowchart

